

FS 413

Spare Parts

Piezas de repuesto

Pieces de rechange

Ersatzteile

Reserveonderdelen

Ricambi

Peças sobresselente

Reservdelar

FS 413

PART NO.	POS.	DESCRIPTION	PART NO.	POS.	DESCRIPTION
501 97 95-02	A	Plate, Engine Mount	542 20 20-99	D	Nut, Clip, M8 X 1.25
501 97 96-02	A	Bracket, Back Axle - Husq	542 20 21-06	A,J1-2	Washer, Snub
502 24 01-05	E	Decal, Control Panel, FS413	542 20 21-13	G	Cable Assy
502 85 62-05	E	Bracket, Console Bearing	542 20 21-16	G	Spacer
504 00 79-01	B	Kit, Blade Shaft Service (Heat Fit)	542 20 21-28	L	Clip, Nose Piece
504 03 12-07	E	Handle	542 20 21-30	J1	Bar, Bent Finished
504 03 12-09	E	Handle w/ Grips	542 20 21-31	J1	Bar, Straight Finished
504 20 75-01	G	Raise/Lower Handle	542 20 21-50	H	Belt, PK Section, 12Gr, 780mm
504 73 65-07	H	Pulley, PK, 67mm - 25.4mm, 12Gr B/O	542 20 21-51	H	Oil Drain - compl
539 30 00-92	G	Key, Woodruff (ANSI #405)	542 20 21-52	H	Hose Assy - Oil Drain
539 30 05-00	H	Engine, Honda GX390	542 20 21-63	E	Wheel, Depth Gauge
539 30 05-56	E	Meter, Tach / Hour	542 20 21-64	E	Bracket Depth Gauge, Zinc Plated
539 91 27-57	H	Key. 0.25 (6.3mm) Sq x 1.25 (31.8)	542 20 21-65	G	Spring, Lifting
539 97 69-41	H	Capscrew, Hex Hd, .375-16 x 1.25, Gr5	542 20 21-66	G	Bracket, Spring Adjust, Pltd
539 99 02-58	G	Nut, Hex 1/2"-13	542 20 21-69	E	Cap Round Vinyl
541 20 51-97	H	Capscrew, Hex Hd, .3125-24 x 1.0", Gr 5	542 20 21-71	D	Plate Rivet, Plated
541 20 71-61	G	Screw Handle - compl	542 20 21-81	I	Cage, Engine - Right
541 20 71-76	G	Hand Crank - compl	542 20 21-82	I	Cage, Engine - Left
541 20 71-88	B	Slinger	542 20 21-84	I,K1,K2	Washer Tube 8mm ID
541 20 72-40	B	Tube, Bladeshaft	542 20 21-85	I	Bar Tank Pivot
541 20 72-41	A,B	Bladeshaft - compl	542 20 21-86	I	Bar Lifting Bail
541 20 81-60	B	Bearing, Ball 62052-RS-C3	542 20 21-87	I	U-Bolt
541 20 81-90	H	Plate Tensioner Black	542 20 21-88	I	Washer Tube 12mm ID
541 20 81-94	H	Spacer Idler Sheave	542 20 22-16	G	Grease Zerk, M8 x 1.0, 90 Deg.
541 20 81-95	H	Sheave Idler	542 20 22-36	E	Cable, Throttle
541 20 81-96	H	Idler Sheave -compl	542 20 22-70	J2	Pointer, Dual - compl
541 20 82-30	N1-2	Bearing 8mm	542 20 22-71	J2	Bar, Outside - Dual Pointer
541 20 82-37	N1	Steel Guard, Rear - Black	542 20 22-74	J2	Bar, Inside - Dual Pointer
541 20 82-40	N1	Steel Guard, Front - Black	542 20 22-83	G	Spring, Extension
541 20 82-45	N1-2	Plate Spade Retaining Finished	542 20 22-89	A	Stud, M10-1.5 x 52mm
541 20 82-46	N1-2	Cover Blade Shaft Finished	542 20 22-92	B	Wrench, 27mm Open
541 20 82-49	N1-2	Blade Guard Pivot Tube Plated	542 20 23-00	G	Capscrew, Hex Hd M12-1.75x190 8.8 DIN 933
541 20 82-63	N1-2	Fitting 1/4 BSP x 6mm Barb 90deg	542 20 23-07	D	Pad, Resilient
541 20 82-65	N1	Tube, 10mm OD x 2mm Wall	542 20 23-08	M	Fitting, Hose Swvl 3/4" FGH x 1/2" NPTM
541 20 82-78	D	Hinge Rubber	542 20 23-09	E	Switch, Stop
541 20 82-79	E	Shoulder Bolt M10 x 30	542 20 23-11	L,M	Bracket, Hose Support
541 20 82-81	D	Latch, 1/4 Turn	542 20 23-15	M	Water Side - compl
541 20 82-84	L,M	Cap, Water	542 20 23-20	M	Tank - Fitting Assy
541 20 82-86	L,M	Tank, Water - compl	542 20 23-21	M	Fitting, 1/2" NPTM x 12mm Barb
542 04 56-40	M	Washer-Filter	542 20 23-34	E	Pin, Locking Z/P
542 13 92-73	C,H	Bearing, Ball 6204-2RS-C3	542 20 23-38	G	Collar, Screw
542 13 95-37	M	Valve, Water 1/2" FPT	542 20 23-40	M	Fitting Adapter, 3/8" NPTM x 1/2" NPTF
542 13 95-68	E	Grip, Handle	542 20 23-42	E	Console - Husq
542 13 97-68	H	Set Screw, Soc hd, M8-1.25 x 6 DIN 916	542 20 23-47	D	Cover Console - Husq
542 16 11-96	A	Isolator, 30-35 Durometer	542 20 23-48	D	Side, Right - Husq Orange
542 16 12-35	D	Decal, PATENT PENDING	542 20 23-49	D	Side, Left - Husq Orange
542 16 27-61	K1-2	Clamp, Cord	542 20 23-50	D	Door, Toolbox - Husq Orange
542 16 66-24	L	Fastener, Tufflock	542 20 23-51	D	Cover, Toolbox - Husq Orange
542 16 71-33	H	Adapter, M12 x 10mm Hose Barb	542 20 23-52	D	Bottom, Toolbox - Husq Orange
542 16 71-85	B	Collar, Inner, 4.50"	542 20 23-59	H	Plate, Belt Guard - Husq Gray
542 16 72-98	N1-2	Decal, Warning, Blade Guard	542 20 23-60	N1	Bladeguard -18" -compl CE - Husq Gray
542 16 73-06	H	Cap - Oil Drain	542 20 23-62	N1	Bladeguard, 18" Rear - compl Husq Gray
542 16 76-22	H	Nut, Tube M16	542 20 23-63	N1	Bladeguard, 18" Front - compl Husq Gray
542 16 78-46	B	Nut, Bladeshaft 5/8-11 L.H.	542 20 23-67	G	Nut Tube - Husq
542 16 78-47	B	Nut, Bladeshaft 5/8-11 R.H.	542 20 23-74	A	Shaft Guard - Husq
542 16 79-62	B	Outer Collar w/ Pin - 4.50" OD	542 20 23-75	H	Belt Guard - Husq
542 16 79-64	B	Pin, Drive 3/8" OD x 1-1/8"	542 20 23-79	G	Insert, Bushing
542 16 90-65	H	Decal, Hot Muffler	542 20 23-94	A	Bracket, Brake - Husq Orange
542 17 21-37	K1-2	Rope, Nylon 4mm Dia	542 20 23-96	A	Spring, Brake Z/P
542 17 79-15	G	Screw, 5/8-8 Acme Thread B/O	542 20 23-97	A	Pin, Brake Handle - Z/P
542 18 22-52	E	Cord, E-Stop	542 20 23-99	A	Brake - compl
542 18 44-55	A	Capscrew, Hex Hd M10-1.5x130 8.8 DIN 931	542 20 24-07	A	Frame - Husq
542 19 04-34	G	Bearing, Flange	542 20 24-16	C	Axle, Front Z/P
542 19 05-88	E	Decal, Depth Gauge	542 20 24-17	C	Axle, Back Z/P
542 19 05-93	D	Decal, Op. Manual Location	542 20 24-20	C	Weldment, Axle - Husq Orange
542 19 06-17	L	Decal, Water Tank	542 20 24-22	C	Lower Framing, Husq Orange - compl
542 19 06-38	E	Decal, Warning, Control Panel	542 20 40-63	N1-2	Spray Jet
542 19 06-46	D	Decal, Local Service	542 20 40-64	N1-2	Splash Flap
542 19 07-12	D	Decal, FS 413	542 20 40-89	N2	Blade Guard - compl 20" [500mm]
542 19 07-33	E	Decal, HUSQVARNA	542 20 40-96	N2	Guard, Rear, Steel - 20" [500mm]
542 19 61-83	M	O-Ring - 210 NPR	542 20 40-97	N2	Guard, Front, Steel - 20" [500mm]
542 19 61-84	M	Fitting, Water Tank	542 20 41-01	N2	Tube, 10mm ODx2mm Wall - 20"
542 20 20-62	C	Washer Plated	542 20 41-13	E	Spring, Conical
542 20 20-75	J1-2	Bushing, Spanner	542 20 41-44	N2	Blade Guard, Rear - compl -20" [500mm]
542 20 20-77	J2	Rod, Threaded M10	542 20 41-45	N2	Blade Guard, Front - compl -20" [500mm]
542 20 20-78	J1	Pointer, Single - compl	542 20 41-49	L	Nose Piece - Husqvarna
542 20 20-93	M	Tank, Water	542 20 41-85	A	Spade, Blade Guard - Husq

FS 413

PART NO.	POS.	DESCRIPTION	PART NO.	POS.	DESCRIPTION
543 04 47-32	H	Washer, Spring			
543 04 55-39	M	Valve, 1/2" BSP			
543 04 55-80	M	Hose, Wate 12mm ID x 18mm OD (Per M)			
543 04 56-10	M	Quick Coupler, Male			
543 04 56-12	M	Quick Coupler, Female			
543 04 57-88	D	Decal, Sound Level 108 dB(A)			
543 04 58-91	D	Wrench 13mm			
543 04 59-32	J1-2	Wheel, Pointer			
543 04 59-49	C	Wheel, Front, 125mm			
543 04 59-51	C	Wheel, Back, 200mm			
543 04 60-31	G	Plug, 1.25" OD			
543 04 78-41	H	Deflector, Exhaust GX270/390			
543 85 01-31	M	Fitting, 1/4" Male x 12mm Barb, 90°			
543 85 03-44	M	Clip, Hose			
543 85 03-59	M	Quick Coupler, Male			
721 61 43-01	A,E	Pin, Cotter 1.6x22 ISO1234 DIN 94			
722 78 18-03	D	Pop Rivet, 3.2 Dia x 6.7mm Alum			
722 79 44-02	D	Pop Rivet, 4.0 Dia x 12.1mm Alum			
724 13 29-51	E,N1-2	Machine Screw, Pan Hd M5-0.8x16 Z/P			
725 22 91-71	E	Capscrew, Hex Hd M4-0.7x12 8.8 DIN 933			
725 22 95-71	M	Capscrew, Hex Hd M4-0.7x20 8.8 DIN 933			
725 23 31-71	N1-2	Capscrew, Hex Hd M5-0.8x20 8.8 DIN 933			
725 23 70-71	E,G	Capscrew, Hex Hd M6-1.0x20 8.8 DIN 933			
725 23 76-71	N1-2	Capscrew, Hex Hd M6-1.0x35 8.8 DIN 933			
725 23 79-51	G	Capscrew, Hex Hd M6-1.0x45 8.8 DIN 931			
725 24 47-71	G,N1-2	Capscrew, Hex Hd M8-1.25x12 8.8 DIN 933			
725 24 49-71	X	Capscrew, Hex Hd M8-1.25x16 8.8 DIN 933			
725 24 53-71	A	Capscrew, Hex Hd M8-1.25x25 8.8 DIN 933			
725 24 55-71	D,J1-2	Capscrew, Hex Hd M8-1.25x30 8.8 DIN 933			
725 24 57-71	D,E	Capscrew, Hex Hd M8-1.25x35 8.8 DIN 933			
725 24 61-71	I	Capscrew, Hex Hd,M8-1.25x50 8.8 DIN 933			
725 24 63-51	I,K1-2	Capscrew, Hex Hd M8-1.25x60 8.8 DIN 931			
725 24 71-51	N1-2	Capscrew, Hex Hd M8-1.25x100 8.8 DIN 931			
725 24 71-71	A,H	Capscrew, Hex Hd M8-1.25x100 8.8 DIN 933			
725 24 73-51	H	Capscrew, Hex Hd M8-1.25x110 8.8 DIN 931			
725 24 93-71	C	Capscrew, Hex Hd M10-1.5x25 8.8 DIN 933			
725 25 01-51	H	Capscrew, Hex Hd M10-1.5x50 8.8 DIN 931			
725 25 03-51	G	Capscrew, Hex Hd M10-1.5x60 8.8 DIN 931			
725 25 05-51	A	Capscrew, Hex Hd M10-1.5x70 8.8 DIN 931			
725 25 15-71	J1	Capscrew, Hex Hd M10-1.5x120 8.8 DIN 933			
725 25 42-51	H	Capscrew, Hex Hd M12-1.75x50 8.8 DIN 931			
729 53 40-01	H	Machine Screw, Pan Hd, 4.2 x 9.5, STS			
731 23 18-01	J1-2	Nut, Hex M8-1.25, PC8 DIN 934			
731 23 20-01	J1-2	Nut, Hex, M10-1.5 8.8 Din 934			
MISC ITEMS & SPECIAL KITS					
731 23 22-01	I	Nut, Hex M12-1.75, PC8 DIN 934	542 20 10-78	NS	IPL Spare Parts: FS413, Husq
732 25 12-01	M	Nut, Hex M4-0.7, Locking PC8 DIN 985	542 20 10-77	NS	OM Op Instr: FS413, Husq, 3-L
732 25 14-01	N1-2	Nut, Hex M5-0.8, Locking PC8 DIN 985	542 20 10-84	NS	OM Op Instr: FS413, Husq, 5-L
732 25 16-01	G,N2	Nut, Hex M6-1.0, Locking PC8 DIN 985			
732 25 18-01	D,E,J1-2,	Nut, Hex M8-1.25, Locking PC8 DIN 985	542 20 11-23	M	Inst. Sheet: Water Tank
732 25 18-01	K1-2,N1-2	Nut, Hex M8-1.25, Locking PC8 DIN 985			
732 25 20-01	A,G,H	Nut, Hex M10-1.50, Locking PC8 DIN 985	504 00 79-01	B	Kit, Blade Shaft Service (Heat Fit)
732 25 22-01	I	Nut, Hex M12-1.75, Locking PC8 DIN 985			
734 11 52-01	E,G,N1-2	Washer, Flat M6 DIN 125	542 20 24-25	E	Kit, Control Panel Decal
734 11 63-01	A,D,E,H	Washer, Flat M8 DIN 125			
734 11 63-01	J2,K1-2	Washer, Flat M8 DIN 125			
734 11 72-01	H	Washer, Flat M10 DIN 125			
734 11 74-41	C	Washer, Flat M10 ISO 7093-10-140HV			
734 11 78-01	G	Washer, Flat M12 DIN 125			
735 11 36-01	E	Washer, Split M4 DIN 127			
735 11 53-01	E	Washer, Split M6 DIN 127			
735 11 64-01	A,D,E,H,I	Washer, Split M8 DIN127			
735 11 73-01	A,C	Washer, Split M10 DIN127			
735 11 78-01	H	Washer, Split M12 DIN 127			
735 31 40-10	H	Snap Ring 47 x 1.75			

A Frame - FS 413

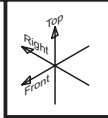

08.13.07

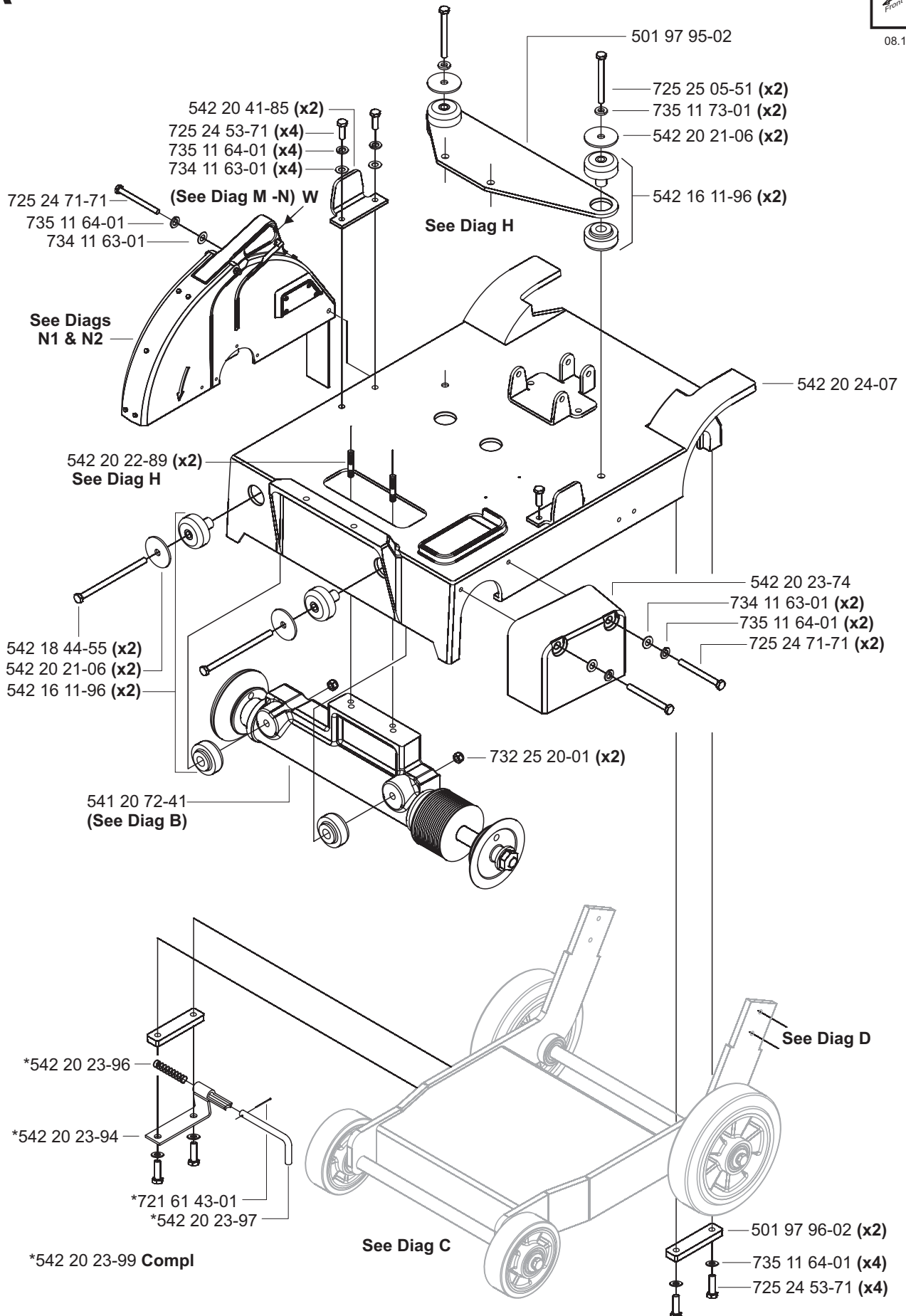

B Bladeshaft

* Compl. 541 20 72-41

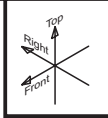

11.08.06

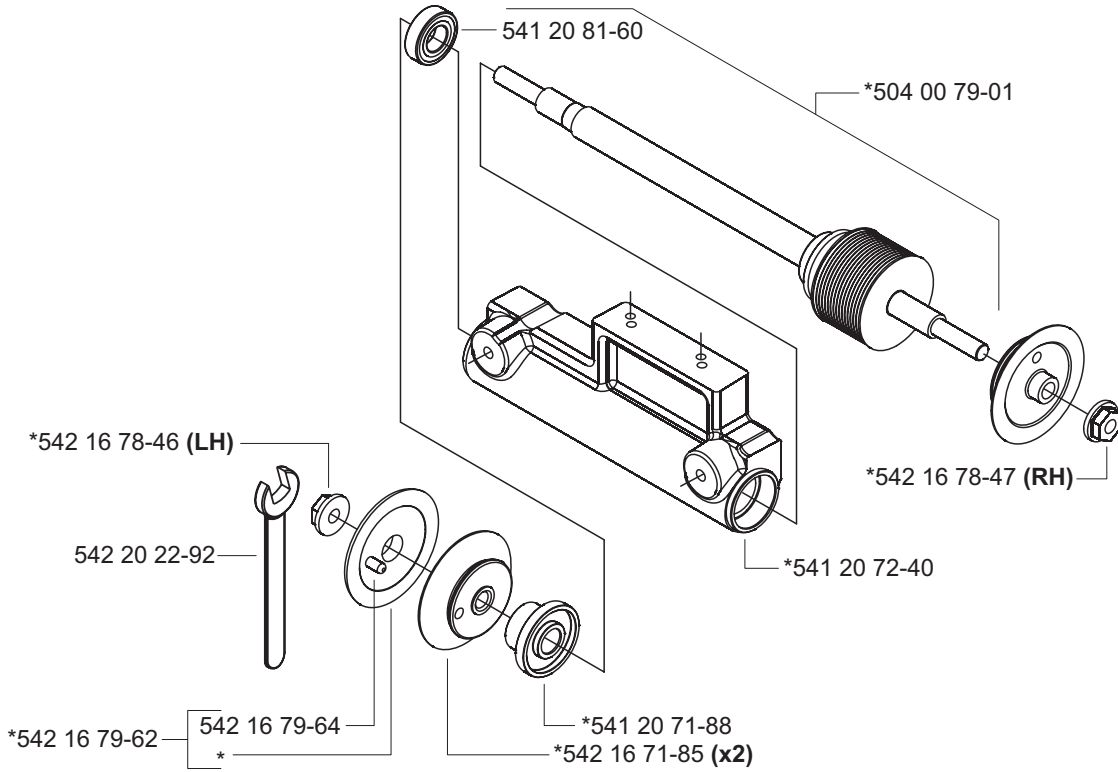

C Lower Framing

542 20 24-22 Compl

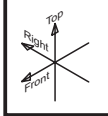

11.06.06

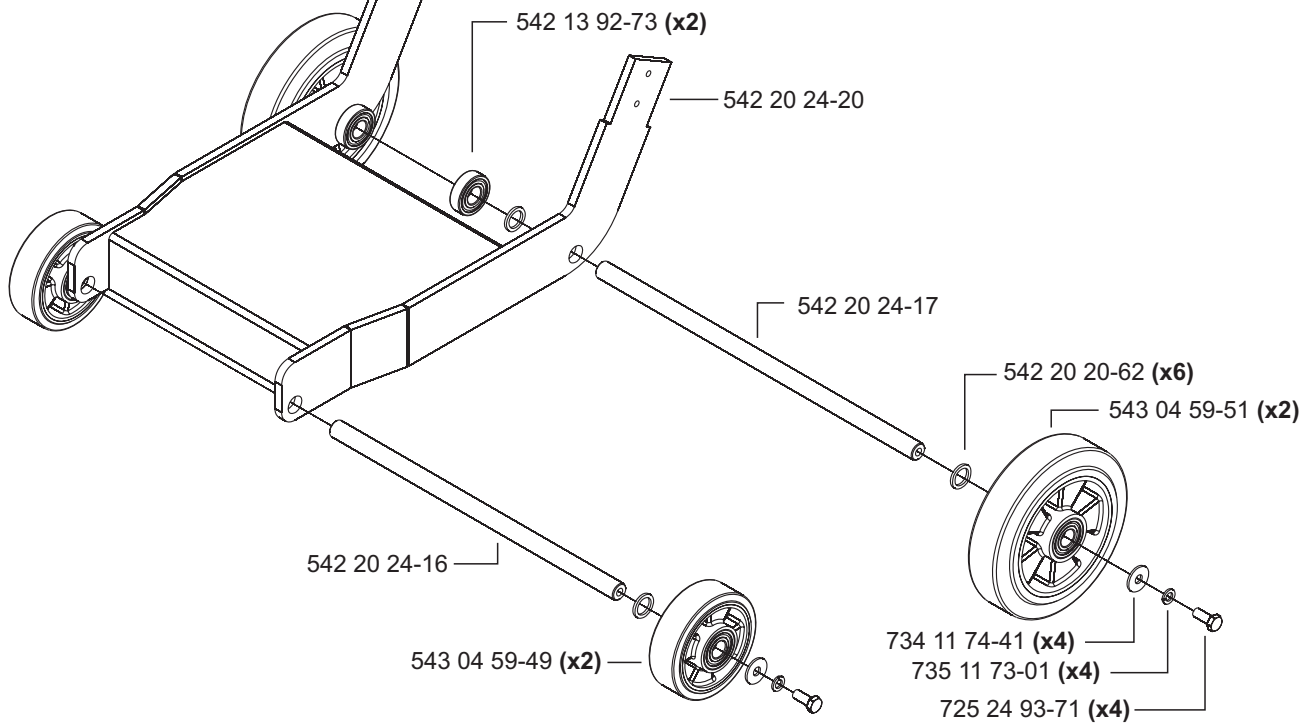

D Toolbox - FS 413

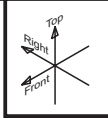

08.13.07

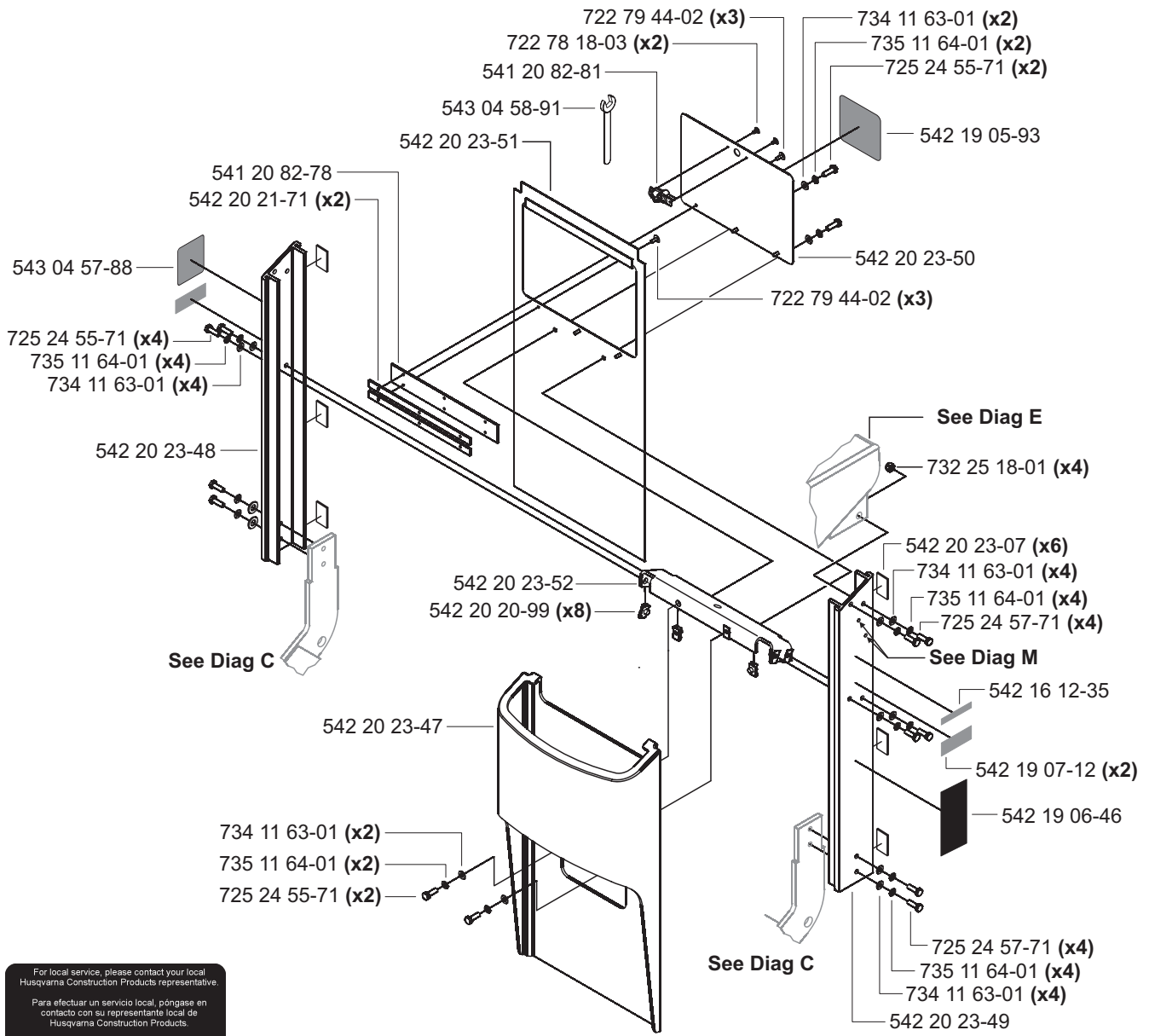

For local service, please contact your local Husqvarna Construction Products representative.

Para efectuar un servicio local, póngase en contacto con su representante local de Husqvarna Construction Products.

Pour toute réparation, contacter le représentant local de Husqvarna Construction Products.

Für Service vor Ort wenden Sie sich bitte an Ihren örtlichen Vertreter von Husqvarna Construction Products.

Neem voor plaatselijke service contact op met uw plaatselijke vertegenwoordiger van de constructieproducten van Husqvarna.

Per assistenza, rivolgersi al rappresentante di zona della Husqvarna Construction Products.

För service på platsen, kontakta din lokala representant för Husqvarna Construction Products.

Para obter serviço técnico local, contactar o representante da Husqvarna Construction Products local.

Europa / Europe:
 Husqvarna
 Construction Products
 SE-433 81 Partille, Sweden
 Tel: +46 31 94 90 50
 Fax: +46 31 94 90 50

Asia Pacific:
 Husqvarna
 Construction Products,
 Australia Pty Ltd
 25-31 Kirkcald Avenue,
 North Plympton, Adelaide,
 South Australia 5037
 Tel: +61 (0)8 8375 1000
 Fax: +61 (0)8 8371 0990

The Americas:
 Husqvarna Construction Products,
 North America
 17400 West 118th Street,
 Olathe, Kansas 66061 USA
 Toll-Free Telephone: 800-288-5040,
 Telephone: 913-928-1300
 Fax: 913-438-7938

— 542 19 06-46



— 543 04 57-88

PATENT PENDING — 542 16 12-35

FS 413 — 542 19 07-12

542 19 05-93

WARNING	
Read And Understand Entire Operation Manual Before Operating Machine!	
Understand All Warnings, Instructions & Controls Before Operating Machine!	
Operation Manual Located Within Machine As Shown Below.	

E Control Console - FS 413

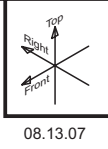

08.13.07

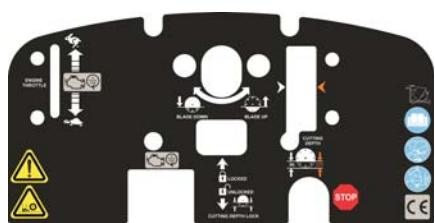
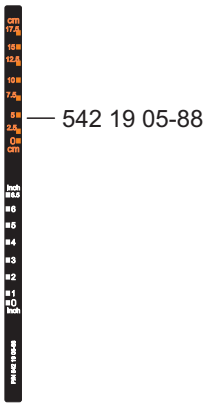
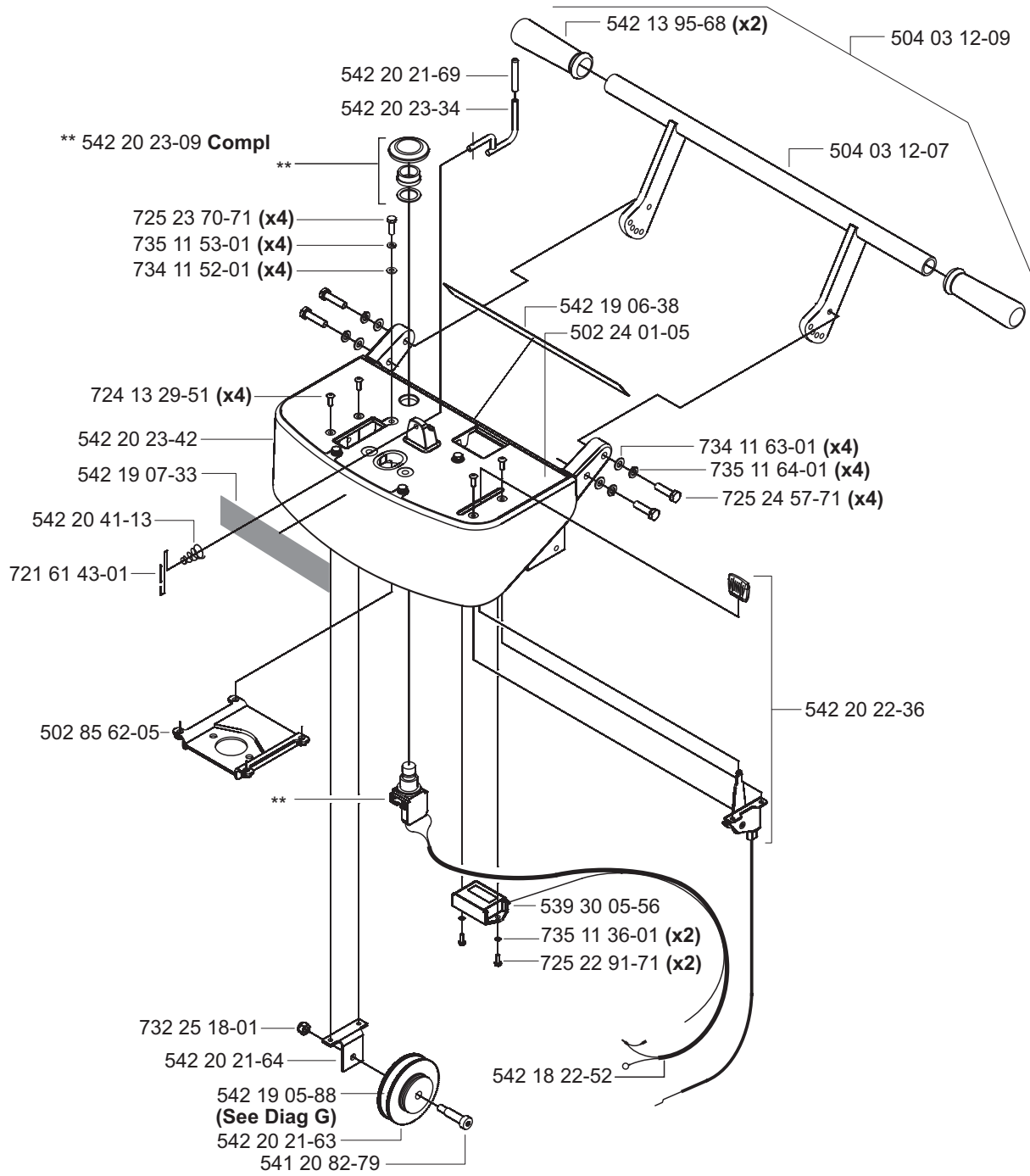

ATTENZIONE! Leggere attentamente il manuale di istruzioni prima di utilizzare l'attrezzo. Leggere attentamente il manuale di istruzioni prima di utilizzare l'attrezzo. Leggere attentamente il manuale di istruzioni prima di utilizzare l'attrezzo.

542 20 24-25

502 24 01-05

542 19 06-38

542 19 07-33



G Screw Feed - FS 413

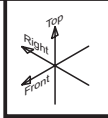

08.13.07

Depth Gauge Spring & Cable

See Diag E

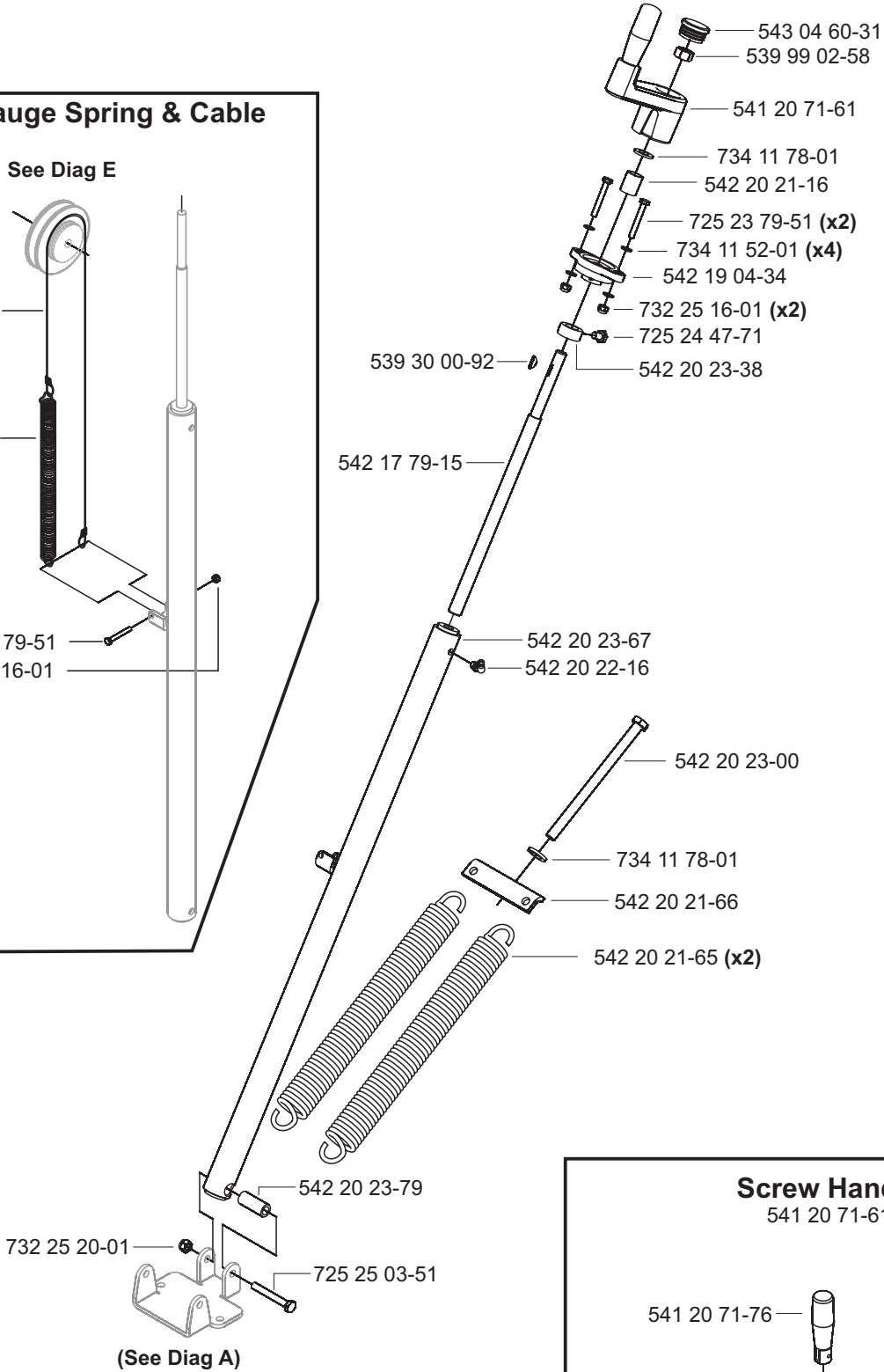
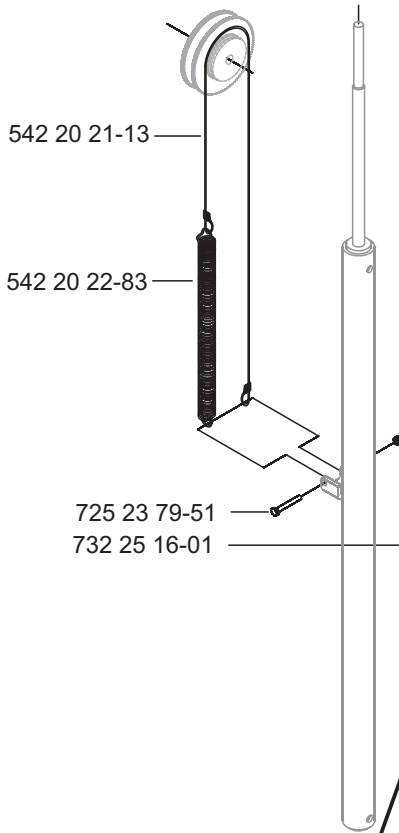

Screw Handle

541 20 71-61

541 20 71-76

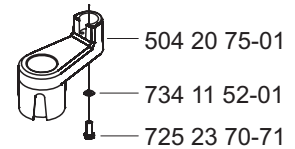

H Engine & Idler - FS 413

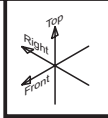

08.13.07

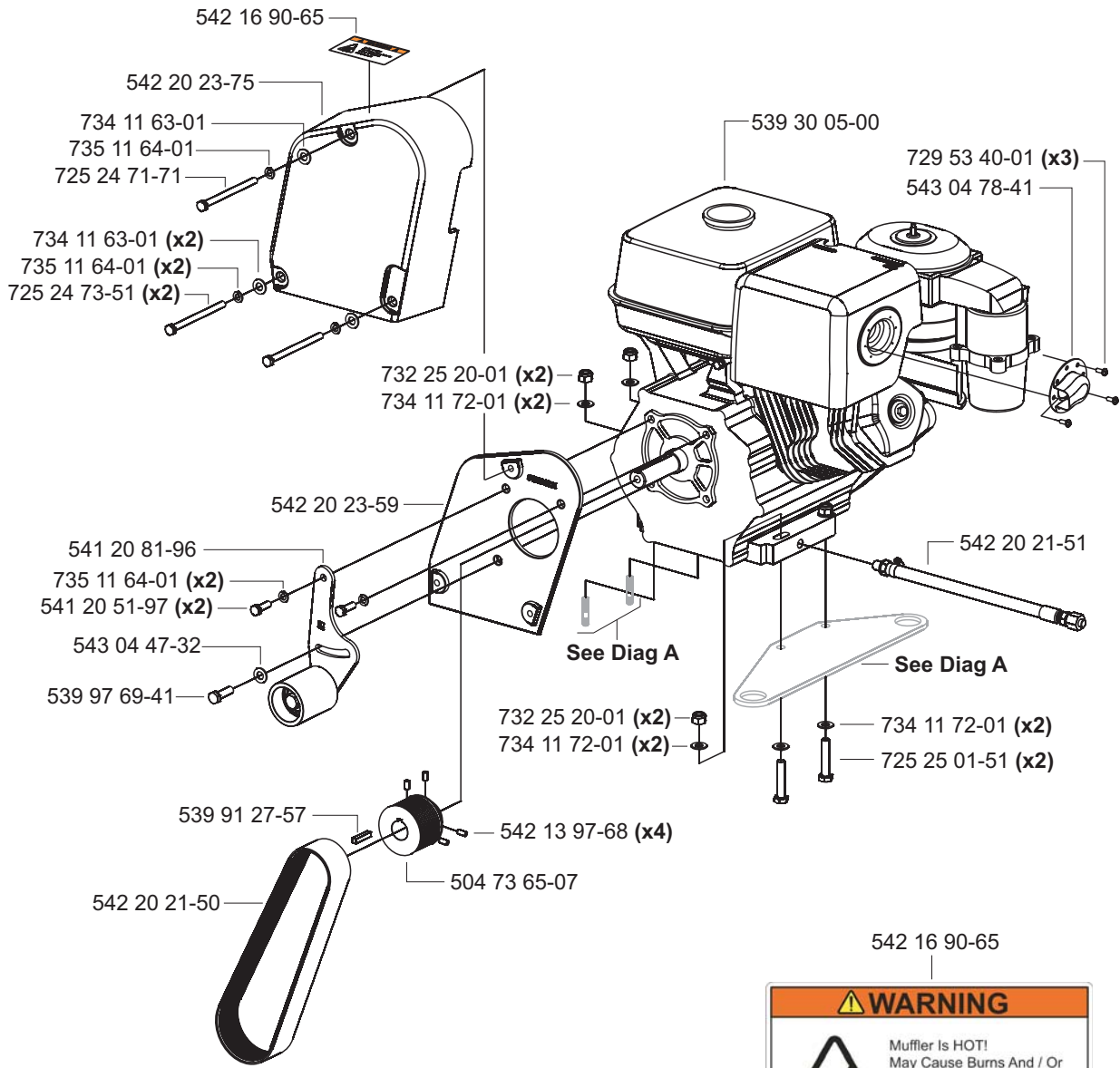

542 16 90-65

WARNING

Muffler Is HOT!
May Cause Burns And / Or
Ignition Of Material.
Avoid Contact!

541 20 81-96 Idler - Compl

05.01.06

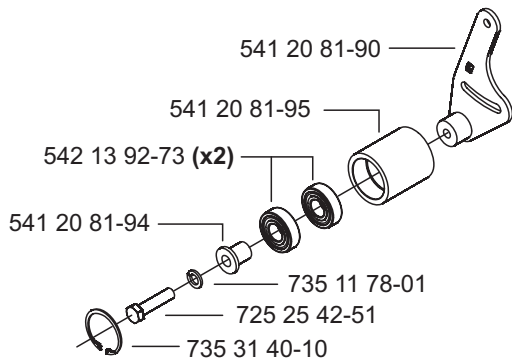

542 20 21-51 Oil Drain - Compl

03.01.06

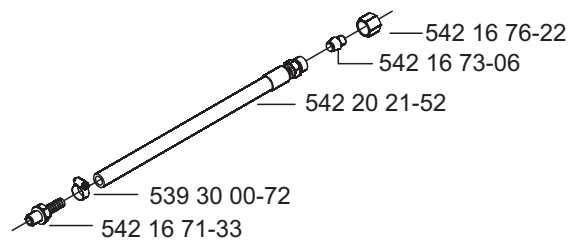

Engine Cage - FS 413

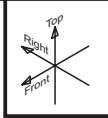

08.13.07

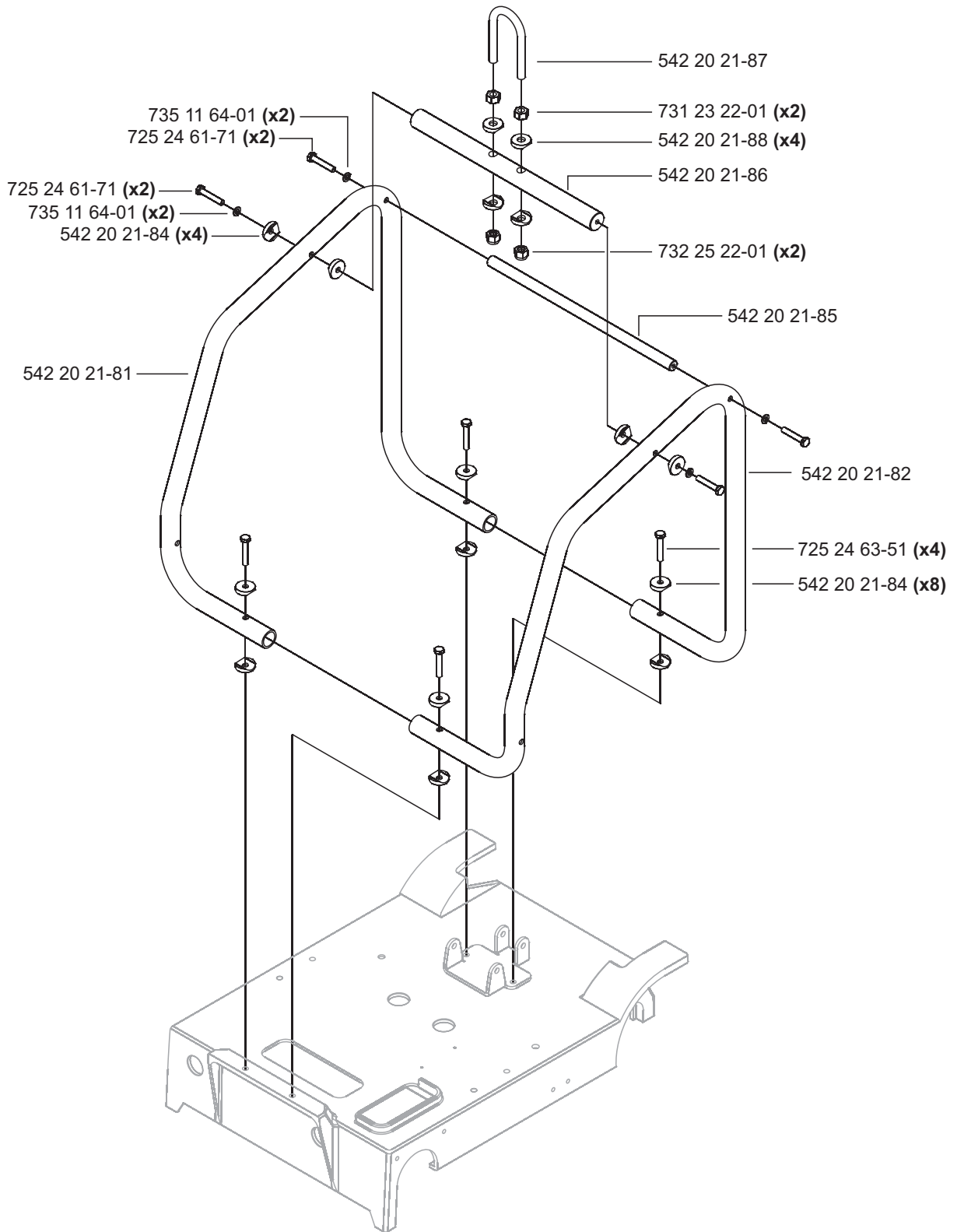

J1 Pointer - ** Single **

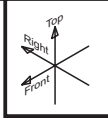

11.09.06

*542 20 20-78 Compl

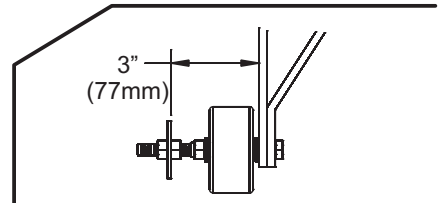
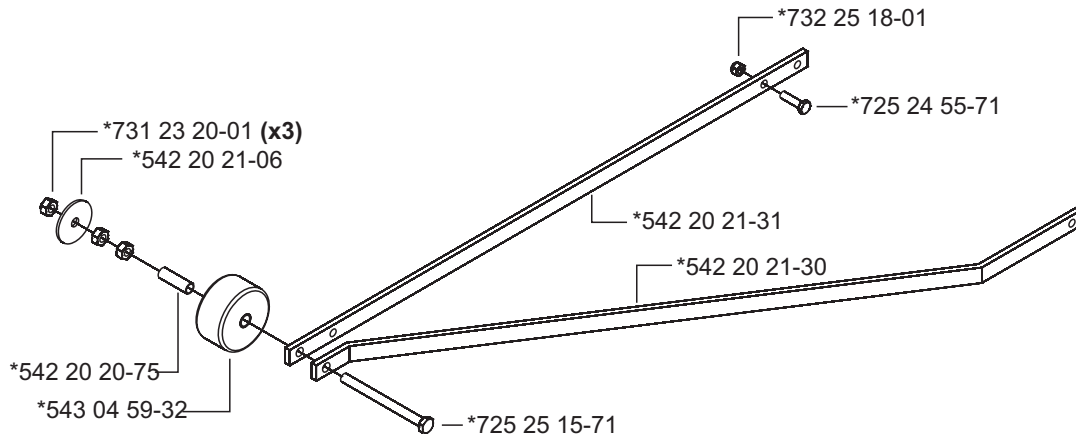

K1 Pointer Attachment ** Single Pointer **

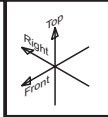

11.06.06

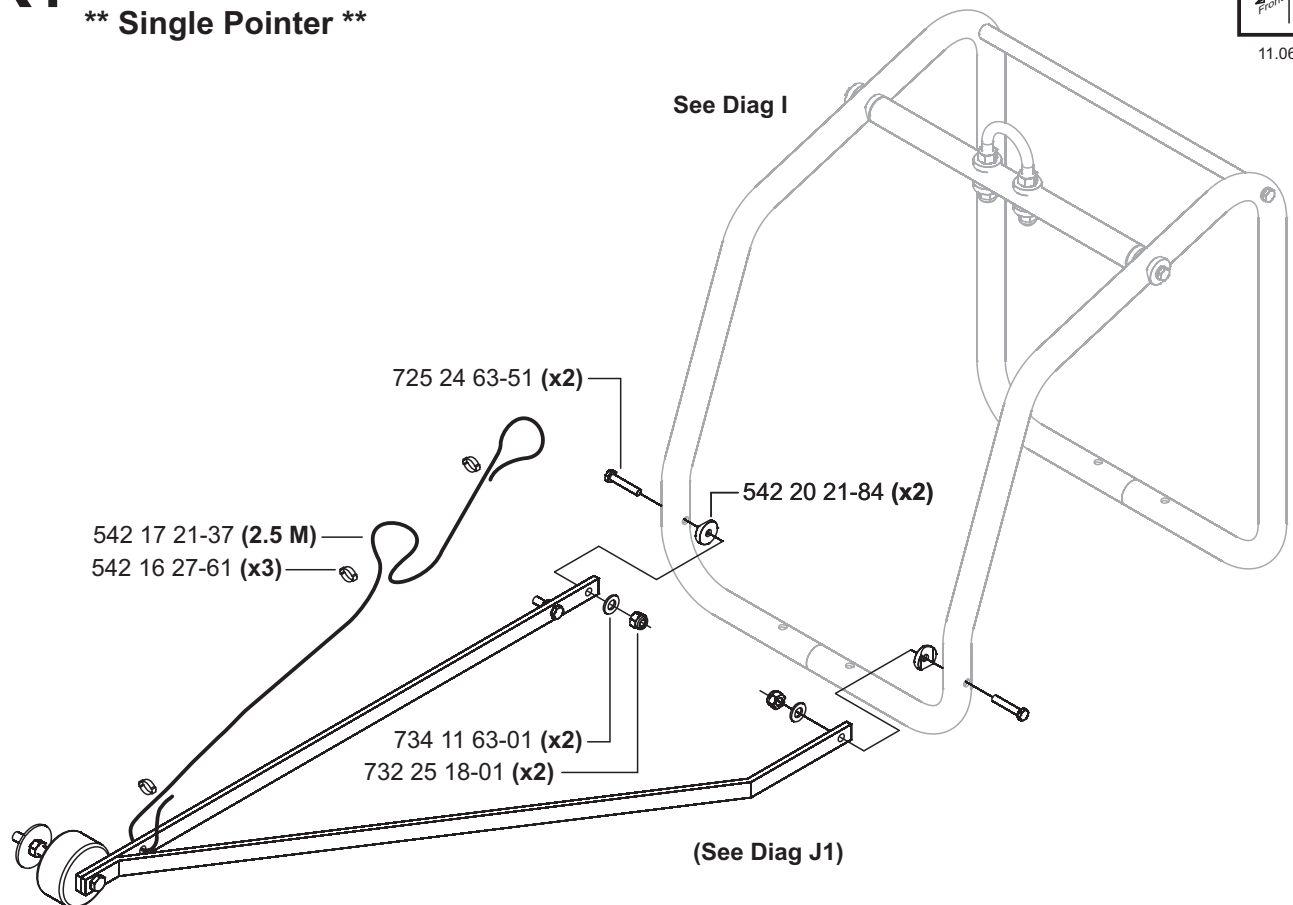

J2 Pointer - ** Dual **

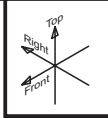

08.13.07

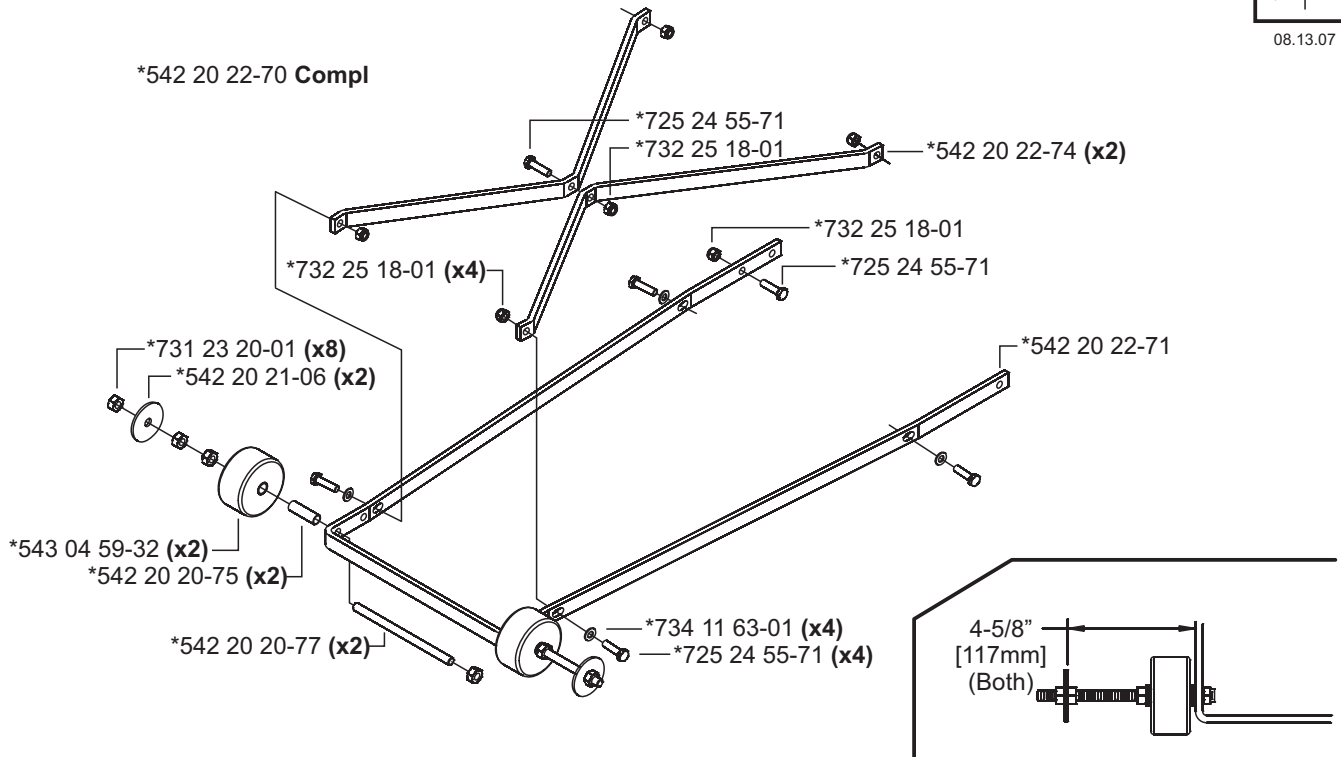

K2 Pointer Attachment ** Dual Pointer **

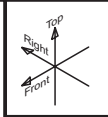

11.06.06

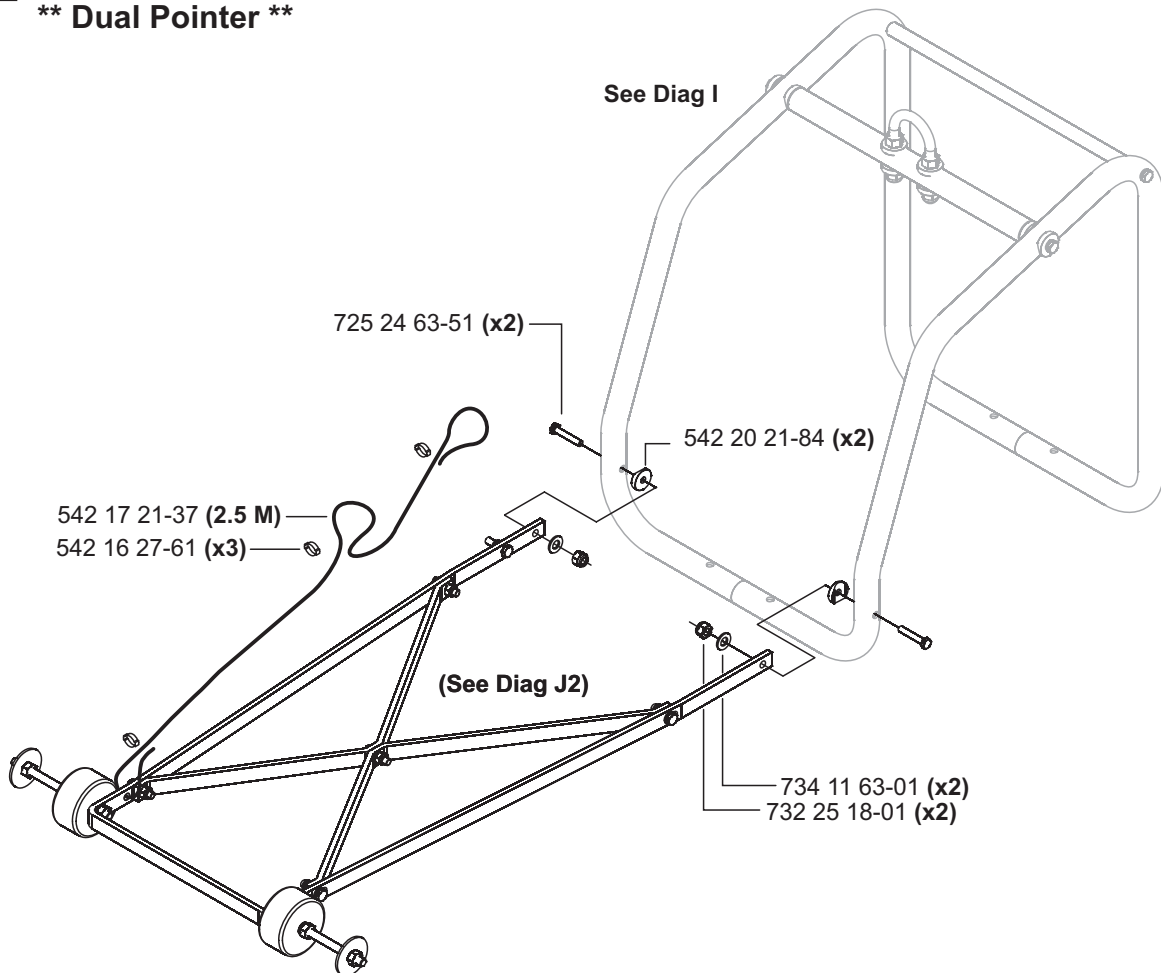

L Water Tank & Nose Piece - FS 413

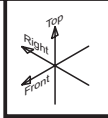

08.13.07

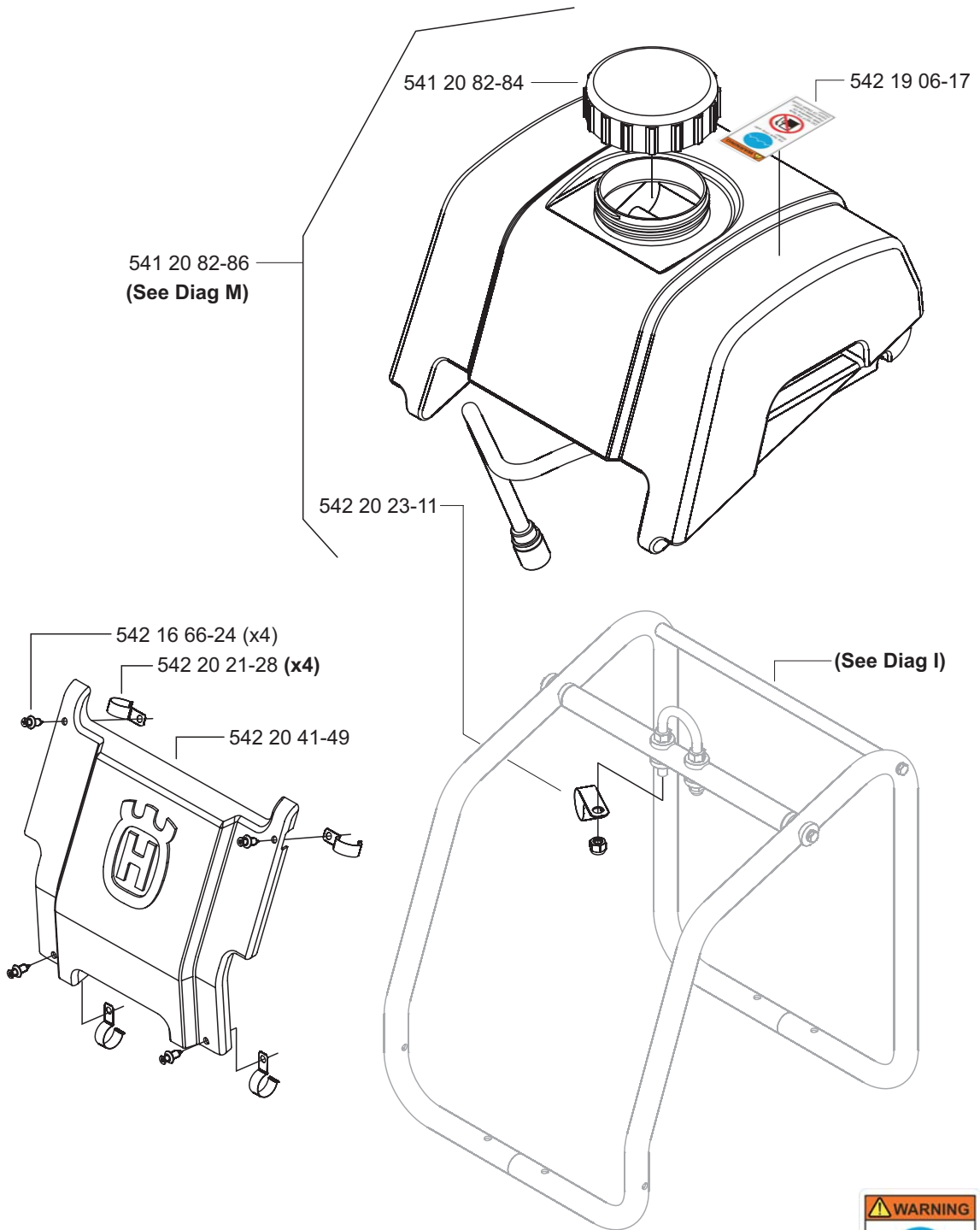

542 19 06-17



M Water System

* 541 20 82-86 Water Tank Assy - Compl (Optional)

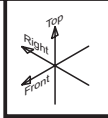

11.06.06

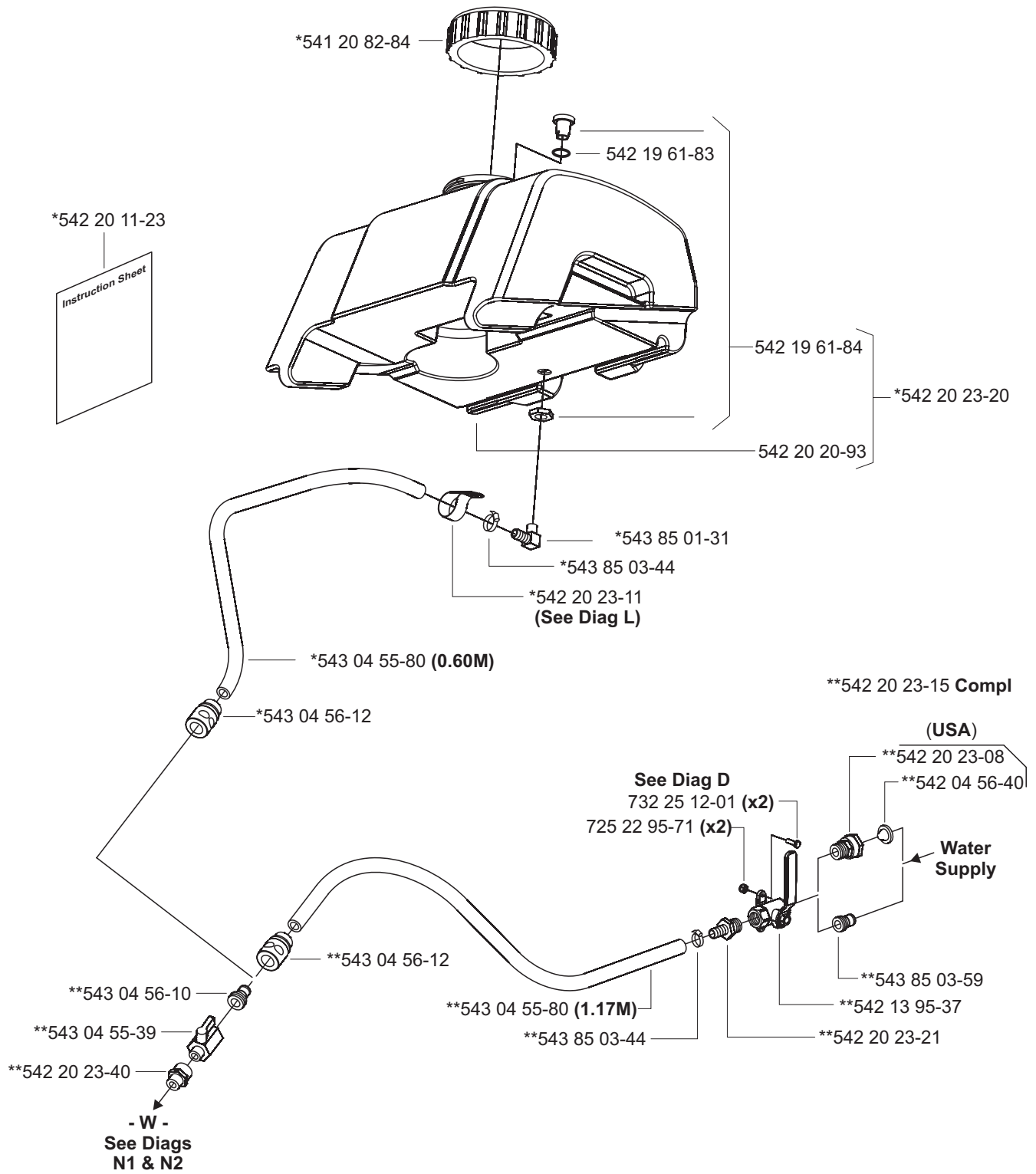

N1 Blade Guard - 18" [450mm]

542 20 23-60 Compl

**542 20 23-62 Rear Guard Compl

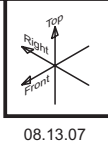

08.13.07

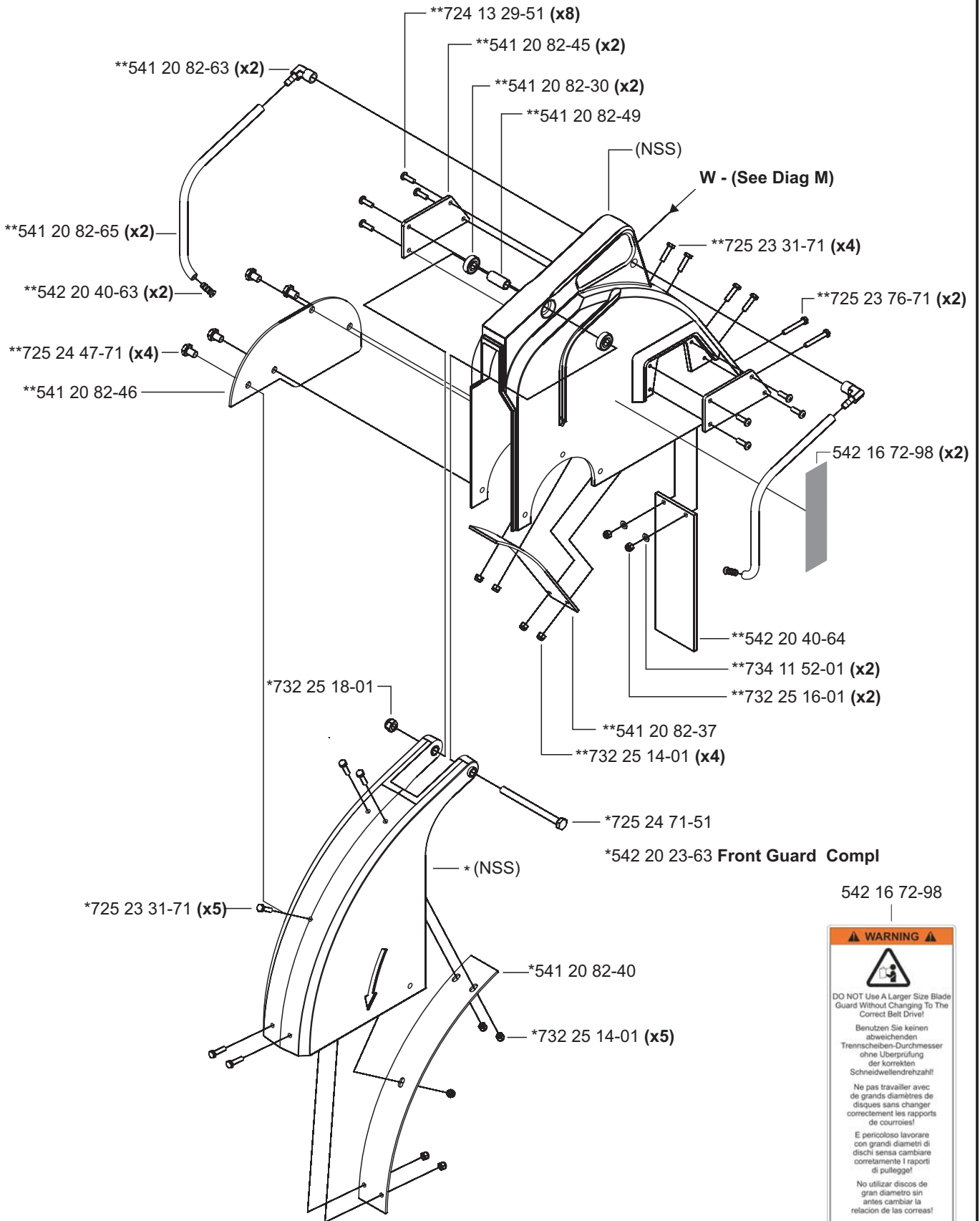

(NSS) - Not Sold Separately

542 16 72-98

WARNING

DO NOT Use A Larger Size Blade Guard Without Changing To The Correct Belt Drive!

Benutzen Sie keinen abweichenden Treibscheiben-Durchmesser ohne Überprüfung der korrekten Schneidwellendrehzahl!

Ne pas travailler avec de grands diamètres de disques sans changer correctement les rapports de courroies!

E pericoloso lavorare con grandi diametri di dischi senza cambiare correttamente i rapporti di pulleggi!

No utilizar discos de gran diámetro sin antes cambiar la relación de las correas!

Gebruik geen zaag-kappen van grotere afmetingen zonder een juiste afstelling aan de riemaandrijving!

N2 Blade Guard - 20" [500mm]

542 20 40-89 Compl

**542 20 41-44 Rear Guard Compl

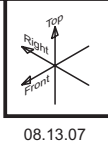

08.13.07

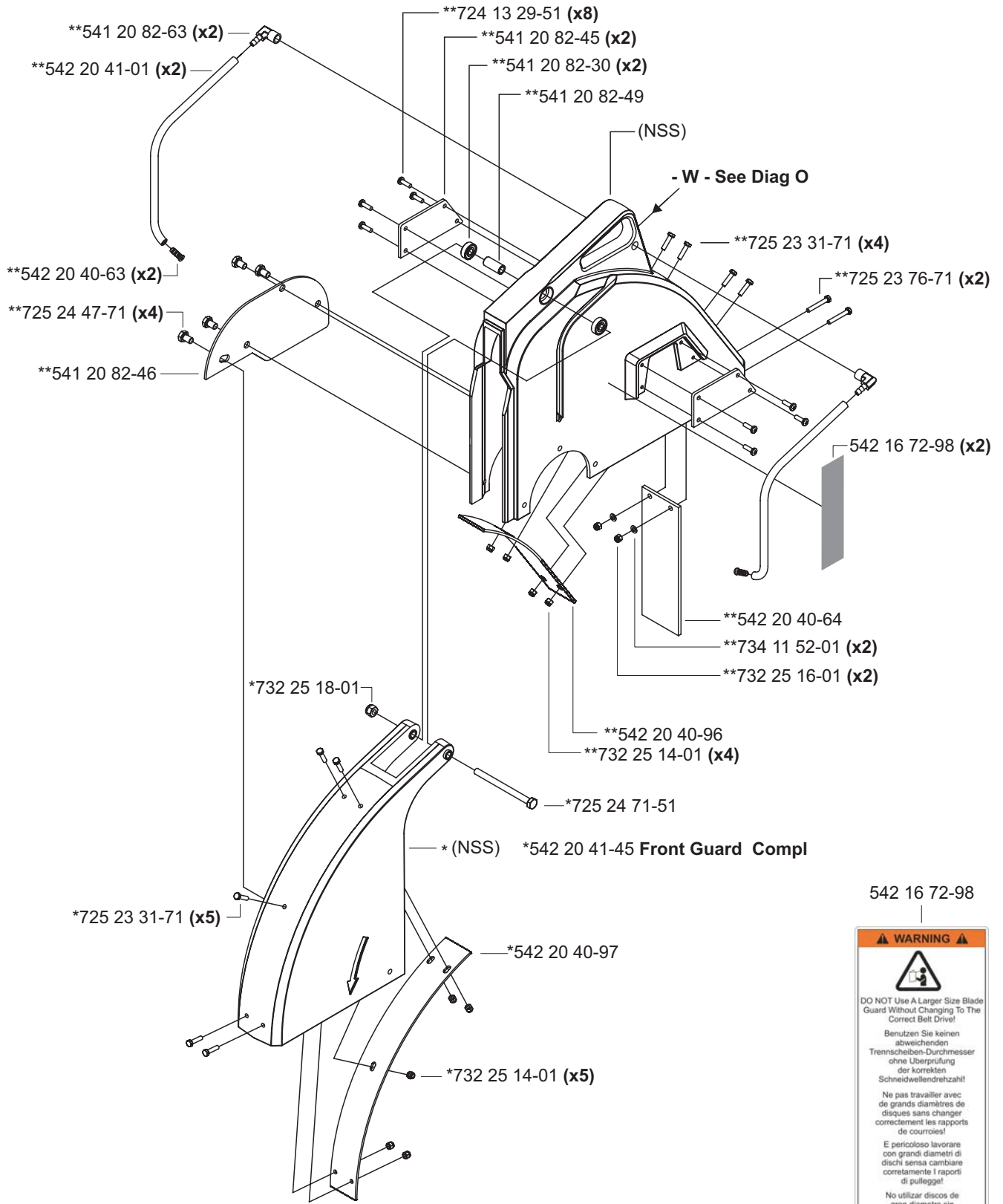

(NSS) - Not Sold Separately

542 16 72-98

▲ WARNING ▲

DO NOT Use A Larger Size Blade Guard Without Changing To The Correct Belt Drive!
 Benutzen Sie keinen abweichenden Treibscheiben-Durchmesser ohne Überprüfung der korrekten Schneidwellendrehzahl!
 Ne pas travailler avec de grands diamètres de disques sans changer correctement les rapports de courroies!
 È pericoloso lavorare con grandi diametri di dischi senza cambiare correttamente i rapporti di pulegge!
 No utilizar discos de gran diámetro sin antes cambiar la relación de las correas!
 Gebruik geen zaag-kappen van grotere afmetingen zonder een juiste afstelling aan de riemaandrijving!

Husqvarna Construction Products, North America

Corporate Office

117400 West 119th Street, Olathe, Kansas 66061 USA
Corporate Office: 913-928-1000
Corp. Office Fax: 913-438-7951

www.husqvarna.com

Europa / Europe:

Husqvarna Construction Products

SE-433 81 Partille, Sweden
Tel: +46 31 94 90 00
Fax: +46 31 94 90 50

Asia Pacific:

Husqvarna Construction Products, Australia Pty Ltd

25-31 Kinkaid Avenue,
North Plympton, Alelaide,
South Australia 5037
Tel:+61 (0)8 8375 1000
Fax:+61 (0)8 8371 0900

The Americas:

Husqvarna Construction Products, North America

17400 West 119th Street, Olathe, Kansas 66061 USA
Toll-Free Telephone: 800-288-5040, Telephone: 913-928-1300
Fax: 913-438-7938



Cutting, especially when DRY cutting, generates dust that comes from the material being cut, which frequently contains silica. Silica is a basic component of sand, quartz, brick clay, granite and numerous other minerals and rocks. Exposure to excessive amount of such dust can cause:

- Respiratory diseases (affecting your ability to breath), including chronic bronchitis, silicosis and pulmonary fibrosis from exposure to silica. These diseases may be fatal;
- Skin irritation and rash; and
- Cancer according to NTP* and IARC*
* National Toxicology Program / International Agency for Research on Cancer

Take precautionary steps

- Avoid inhalation of and skin contact with dust, mist and fumes;
- Wet cut when feasible, to minimize dust;
- Wear and ensure that all bystanders wear appropriate respiratory protection such as dust masks designed to filter out microscopic particles. (See OSHA 29 CFR Part 1910.1200)

California Prop 65 Warning:

Use of this product can cause exposure to materials known to the State of California to cause cancer and/or birth defects or other reproductive harm.



Printed in China